

# Mono-crystalline Solar PV Modules

**M210**

**280W**

**ZJNAC-280M**

**Mono Single Glass Module**

**20.7%**

Module efficiency

## Electrical Specifications

Module Type		ZJNAC-280M	
STC: AM1.5 Temperature 25°C Irradiance 1000 W/m <sup>2</sup>	Peak Power(Pmax)±3%	(W)	280
	Power Tolerance	(W)	0~+5
	Max.Power Voltage(Vmp)	(V)	31.86
	Max.Power Current(Imp)	(A)	8.79
	Open-circuit Voltage(Voc)±3%	(V)	37.86
NMOT: AM1.5 Temperature 20°C Wind speed 1m/s Irradiance 800 W/m <sup>2</sup>	Peak Power(Pmax)±3%	(W)	209.4
	Max.Power Voltage(Vmp)	(V)	29.75
	Max.Power Current(Imp)	(A)	7.04
	Open-circuit Voltage(Voc)	(V)	34.75
	Short-circuit Current(Isc)	(A)	7.62
Operating Temperature	(°C)	-40~+85	
Max. Series Fuse Rating	(A)	15	
Max. System Voltage(DC)	(V)	1500(IEC)	

## Mechanical Specifications

Solar Cells	P-Mono-210*105mm
Arrangement	Type-4*14
Front Glass	3.2mm tempered glass
Backsheet	Fluoride on both sides
Frame	Anodized aluminium alloy
Junction Box	IP68, 2 diodes
Cables	4.0mm <sup>2</sup> photovoltaic cables
Connectors	MC4 compatible/IP68
Maximum Load Capacity	Snow-3600Pa/Wind-1600Pa
Safety Rate	Class II (IEC)
Fire Rate	Class C (TUV)

## Packing Configuration

Package Weight & Size	14.3Kg/carton & 1547*892*38mm		
20'GP Container	1 pcs/carton	534 cartons/20'GP	534 pcs
40'HQ Container	1 pcs/carton	1316 cartons/40'HQ	1316 pcs

## Dimensions of PV Module

Module Dimensions 1535(±2)\*880(±2)\*30mm

Module Weight 13.5 kg(±3%)

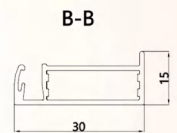
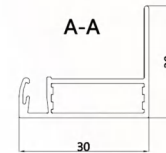
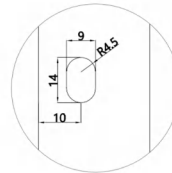
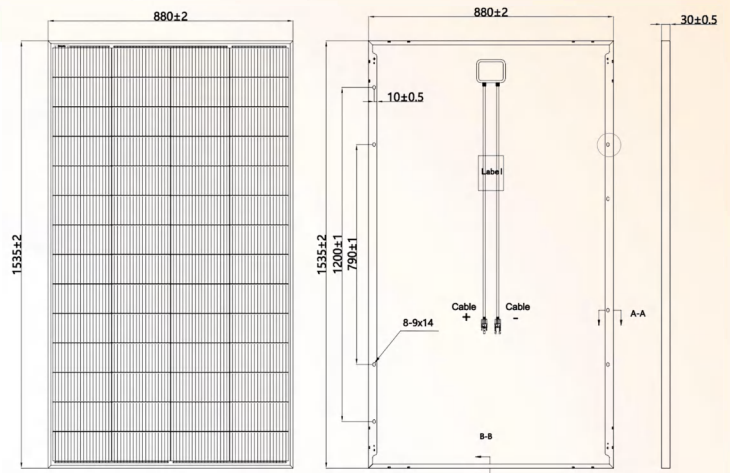

## Temperature Characteristics

Temperature Coefficient (Pmax)	δ[%/°C]	-0.36
Temperature Coefficient (Voc)	β[%/°C]	-0.30
Temperature Coefficient (Isc)	α[%/°C]	+0.046
Nominal Operating Cell Temperature	NMOT	44°C±2°C

## I-V & P-V Curves

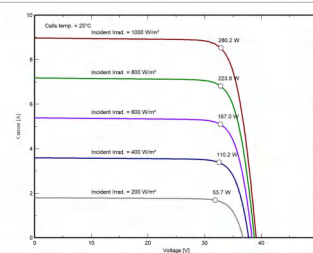

Current-Voltage Characteristic

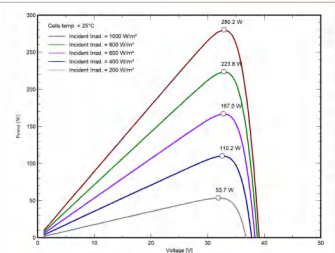

Power-Voltage Characteristic

Configuration	Default	Choose
Frame Color	<input checked="" type="checkbox"/> Silver	<input type="checkbox"/> Black
Backsheet Color	<input checked="" type="checkbox"/> White	<input type="checkbox"/> Transparent <input type="checkbox"/> Black
Cable Length	<input checked="" type="checkbox"/> 900mm	<input type="checkbox"/> Customization
Connectors	<input checked="" type="checkbox"/> Compatible MC4	<input type="checkbox"/> Original EVO2



ZHEJIANG NATIVE PRODUCE&ANIMAL BY-PRODUCTS I/E GROUP CO.,LTD  
ZHEJIANG G&F FOREIGN TRADING CO.,LTD  
Address : No. 308 North Zhongshan Road, Hangzhou, Zhejiang

Tel:+86-0571-85773914  
Mob:+86-13705717473  
E-mail:yangchuang@zjnc.com  
Web:www.zjnc.com